



reddot winner 2025  
office design



# NOBIUS3.0

Collaborative

NOVAH





***BOUNDED SILENCE,  
BOUNDLESS VIEWS***

# Next Philosophy: Focused Workspaces

With the widespread adoption of Activity-Based Work (ABW) environments, the accompanying noise issues have had a significant impact on employees' physical and mental well-being. Research data indicates that sensitivity to and demands for noise vary across different industries and job roles. Flexible soundproofing solutions can effectively meet diverse work requirements, enhancing overall office efficiency.

## Focused Workspace Demand Across Different Job Roles and Industries



- ※ Focus-Oriented Roles: Roles that require high levels of concentration, such as R&D positions.
- ※ Communication-Oriented Roles: Roles with frequent communication, such as marketing and product management.
- ※ Support Roles: Back-office positions, such as legal and finance departments.

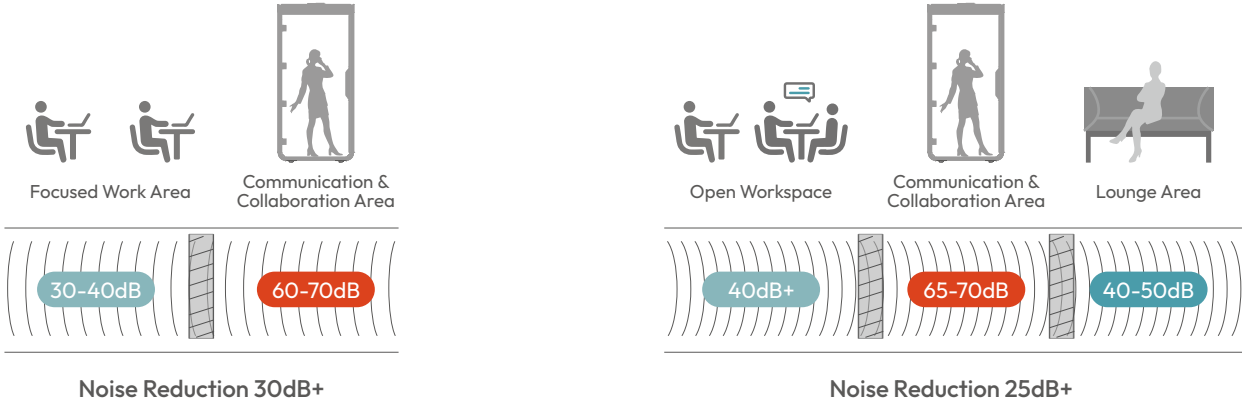

- ※ **A-Class Soundproofing:** Ideal for focused work areas, such as research and development roles, where minimizing external distractions is essential to ensure thought continuity and high work efficiency. It is also suitable for roles involving confidential information, such as finance and human resources.
- ※ **B-Class Soundproofing:** Suitable for general open office areas, such as marketing and product management, where frequent communication and collaboration are required. This type of environment balances quietness with flexible interaction.



### Acoustic Environment

A quiet environment enhances work efficiency.



### Fresh Air

Smooth ventilation improves the overall work experience.



### Adequate Lighting

Sufficient and adjustable lighting reduces visual fatigue.

### Ergonomics

Centered around employee needs, creating a comfortable and focused work environment.



### Energy Efficiency & Sustainability

Low energy consumption with high efficiency, reducing carbon footprint.



### Flexibility

Adapts to diverse office scenarios, supporting different work styles and needs.





**1 Person**  
W1100\*D1000

**2 Person**  
W2200\*D1000

## Designing the office with unlimited possibilities

Whether for collaboration, focused work, or video calls, stepping into a Nobius soundproof pod offers a calm without feeling cramped. The Nobius series creates a healthy, efficient, and comfortable



**4 Person**  
W2200\*D1860

Pod brings immediate  
to work environment.



# Skylight Design

## Natural Integration into the Space

Looking for tranquility and focus in a noisy, bustling office? The all-new Nobius 3.0 soundproof pod, with its unique curved transparent skylight design, brings you into the embrace of natural light. No longer reliant on artificial lighting, every moment during the day is bathed in soft natural light, reducing eye strain, protecting your vision, and truly enabling eco-friendly workspaces.



reddot winner 2025  
office design





# Natural Lighting & Energy Efficiency

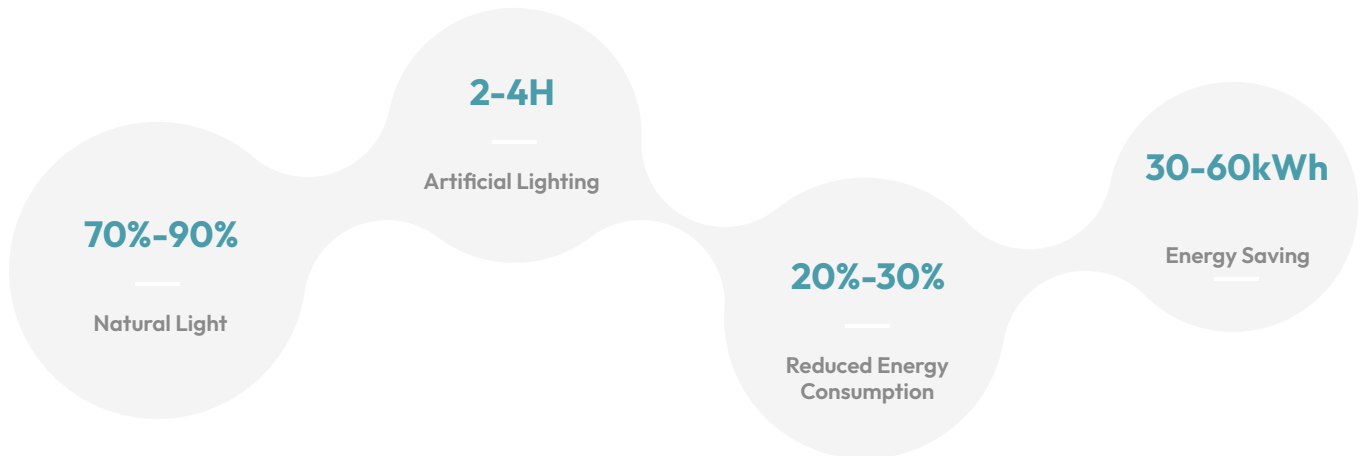

Estimated Data Source: Based on statistics of daily daylight duration and average office hours.

# Sense of Openness and Comfort

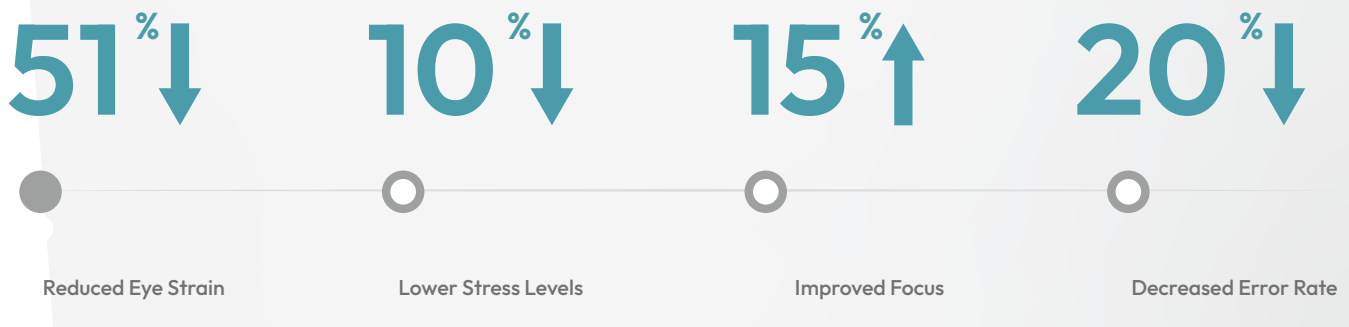

# High-Performance Acrylic Material

## Safe & High Strength

Impact resistance is 16-17 times that of ordinary glass, with a 4H surface hardness rating.

## Lightweight & Easy to Install

50% lighter than ordinary glass, making installation easier.

## Anti-Yellowing & Superior Transparency

Over 92% light transmittance, resistant to yellowing for 7+ years outdoors and 10+ years indoors.

## Eco-Friendly & Recyclable

Recyclable, durable, and waste-reducing for greater sustainability.

# Efficient Work,

Nobius 360° Exterior



# Instant Insight.

for Occupancy Light



# Automatic Sensing & Energy Control



## Improving Collaboration and Communication Efficiency

- Employees spend an average of **38.4 minutes** per day on phone calls.
- Each phone booth can support **7-8 conference calls** daily.
- Around **2.6 employees** in the surrounding work area make or receive calls at their desks.
- Assuming it takes an average of **3 minutes** to find an available phone booth.
- Each phone booth saves **58.5 minutes** of employee work hours per day.
- Each phone booth can enhance collaboration efficiency by approximately **250 hours** per year.



- Clear Visibility up to 30 Meters.
- 360-Degree Recognizable.

Automatic Turn-off After 5 Minutes.

ks.  
ar

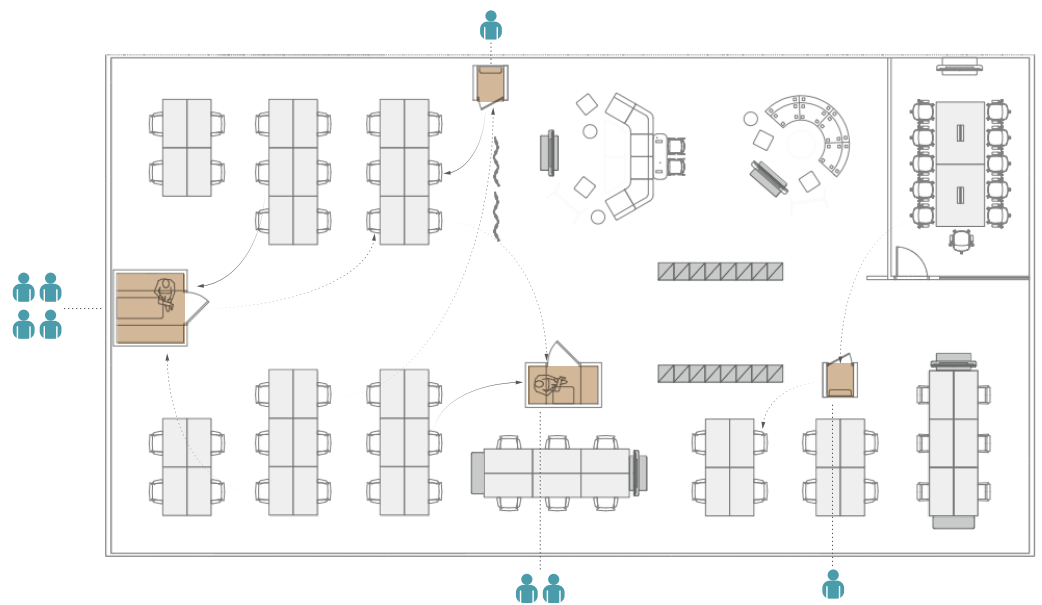

Nobius 3.0



## Interchangeable Panels, Fully Customizable

The interior padding of the Nobius 3.0 soundproof pod is easily removable and replaceable, allowing you to change the color or material at any time to create your own unique office atmosphere.

## Quick Assembly

The Nobius 3.0 is composed of six modular components. Upon delivery, a single-person pod can be assembled by two people in just one hour. Featuring a modular docking structure and bi-directional foolproof design, it ensures efficient installation and precise connections.



## Movable with Wheels

Equipped with concealed wheels at the base, the pod can be easily relocated by adjusting through the access holes above the carpet. Ideal for rearranging office layouts.



## Stand or Sit One Space Two Modes

Easily adjust desk height to switch work modes. Sit to focus, stand to inspire—seamlessly adapt to every creative moment.







**Class A Soundproofing Standard**

**30dB+**

Certified by Intertek,  
tested according to ISO 23351-1 standards.

**Internal Ventilation Rate**

**43sec**

Equipped with high-power silent fans,  
enabling full air circulation inside every minute.

**Workspace Illumination**

**500Lux**

Fitted with 4000K LED eco-friendly light tubes,  
providing up to 500 lux of illumination on the workspace.



**Certified by Intertek,  
tested according to ISO 23351-1 standards.**

This standard measures the reduction of speech levels within the frequency range of human voice inside a phone booth under laboratory conditions. A higher rating indicates lower speech intelligibility and superior sound insulation performance.



## Concealed Ventilation Design

Featuring discreet ventilation openings and enhanced fan speed for greater comfort. The internal air exchange rate can be adjusted up to 144 cubic meters per hour, ensuring full air circulation within 43 seconds.

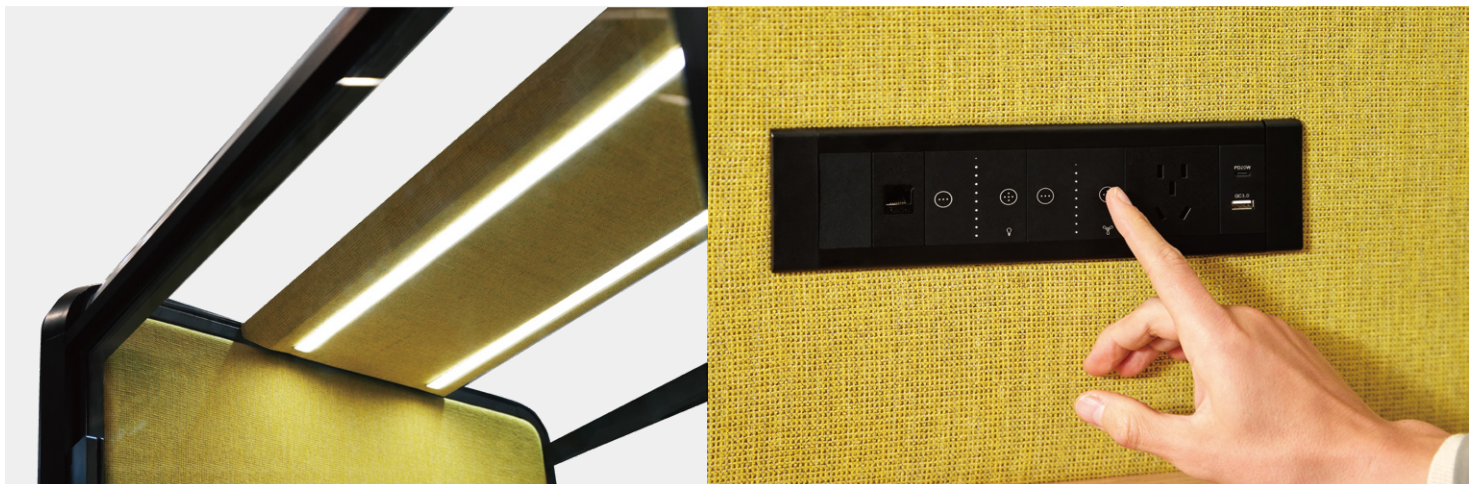

## Multi-Scene Lighting Needs

Fitted with 5000K LED eco-friendly light tubes, providing up to 0-500 lux of illumination on the workspace. Standard equipped with a dual-control 9-level adjustable system for lighting and ventilation, allowing flexible adjustment of brightness and airflow to suit your needs.



## Rotatable Desk Design

The interior desk features a rotatable design, allowing a **30°** left or right rotation with a gentle lift, making entry more convenient.

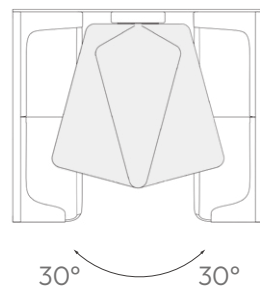

## Ergonomic Sofa

Designed based on ergonomic principles, it conforms to the natural curves of the body and provides exceptional spinal support. Crafted with high-resilience, comfortable materials, it offers an ideal balance of softness and support for a superior seating experience.



# ESG Environmental and Sustainable Design

The Nobius 3.0 series is designed to stay ahead of the times, offering a sustainable solution. Its structure allows all components to be easily upgraded or replaced.

All connections are detachable, enabling modules and materials to be separated with ease, either for reuse within the collection or through our recycling center. This approach helps us minimize material waste and overall waste generation.

Material	Weight Percentage (%)	Recyclable Percentage (%)
Steel	38%	95%
Aluminum	11%	90%
Glass	24%	90%
Acrylic	3%	10%
Plywood	2%	30%
Damping Felt	11%	0%
Soundproof Cotton	2%	0%
Sponge	3%	0%
Electrified Components	1%	20%
<b>Total</b>	<b>100%</b>	<b>72.6%</b>

Nobius utilizes reusable and recyclable packaging materials, and its design ensures that all components are easy to disassemble.





- Iron ①
- Aluminum ②
- Acoustic felt ③
- Eco-friendly fabric ④
- Spray-coated steel plate ⑤
- Doble-layer laminated glass ⑥





Seda Spanish  
(Silk)  
Printed - Passiva - Front  
Umbar  
Recap - Seco  
JPEL - Naoah  
Material Mesh - Nylon - Side Swivel  
Control mesh - Flexion - Side Swivel  
Headrest  
Neckrest



# NOBIUS3.0



**NOVAH System Technology Co.,Ltd.**

Tel: 400-115-1688

Web: [www.novah.cc](http://www.novah.cc)

Mail: [int@novah.cc](mailto:int@novah.cc)

**NOVAH**