

Dyna_Pro

Single-sided Workstation

NOVAH[®]

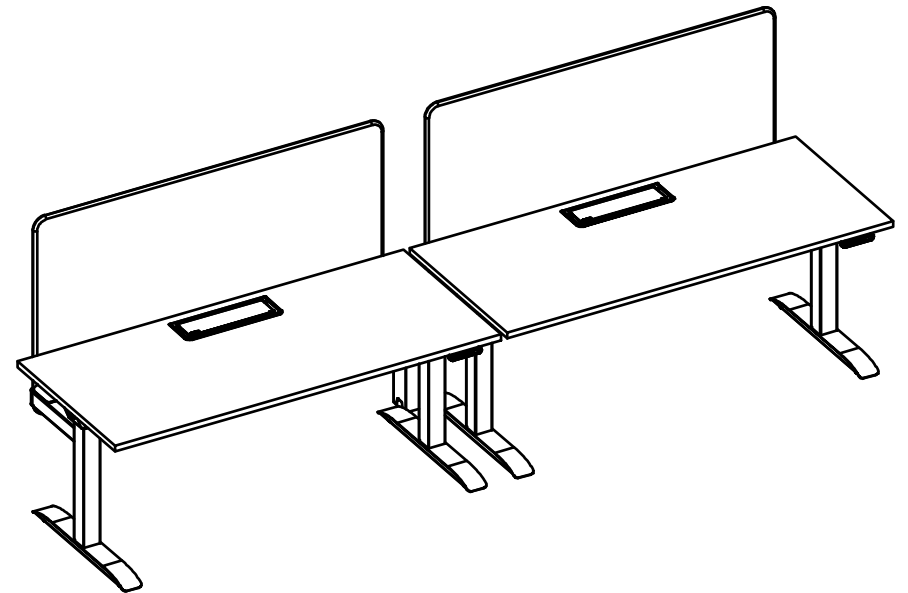

NOVAH System Technology Co.,Ltd.
Tel: 400-115-1688
Web: www.novah.cc
Mail: int@novah.cc

NOVAH[®]

Product Parts List



(Hexagon socket cylindrical head screw M6-12)



(Hexagon socket cylindrical head screw M6-16)



(Hexagon socket cylindrical head screw M6-14/Blackening)



(Hexagon socket cylindrical head screw M6-40)



(Cross big flat head self-tapping screws ST5.5-20)



(Cross recessed pan head tapping screw ST3.5-16)



(Cross recessed pan head tapping screw ST3.5-12)



(Cross recessed pan head tapping screw ST3.5-12)



(Hexagon socket cylindrical head screw M8-12)
(Optional ABS flip-top)



(Cross big flat head self-tapping screws ST5.5-20)
(Optional ABS flip-top)

Step 1

1. Place ① the lifting column and ④ undertable wireway as shown in the figure

2. Install ① the lifting column + ② bottom feet + ③ adjustable feet

Sheet metal feet

(Hexagon socket pan head screw M6-16)

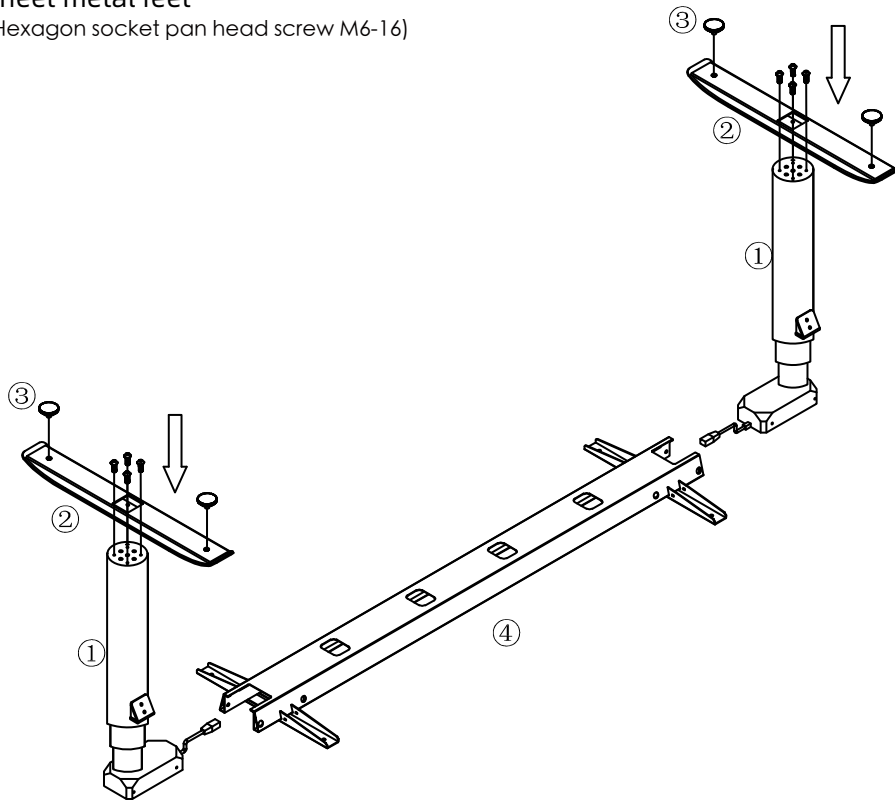

Step 2

1. Install ① the lifting column and ④ undertable wireway (Hexagon socket cylindrical head screw M6-12)

2. Install ① the lifting column and ⑤ connecting pipe (Hexagon socket cylindrical head screw M6-14/Blackening) Pay attention to the direction of the incoming wire opening

3. Table stand turning over

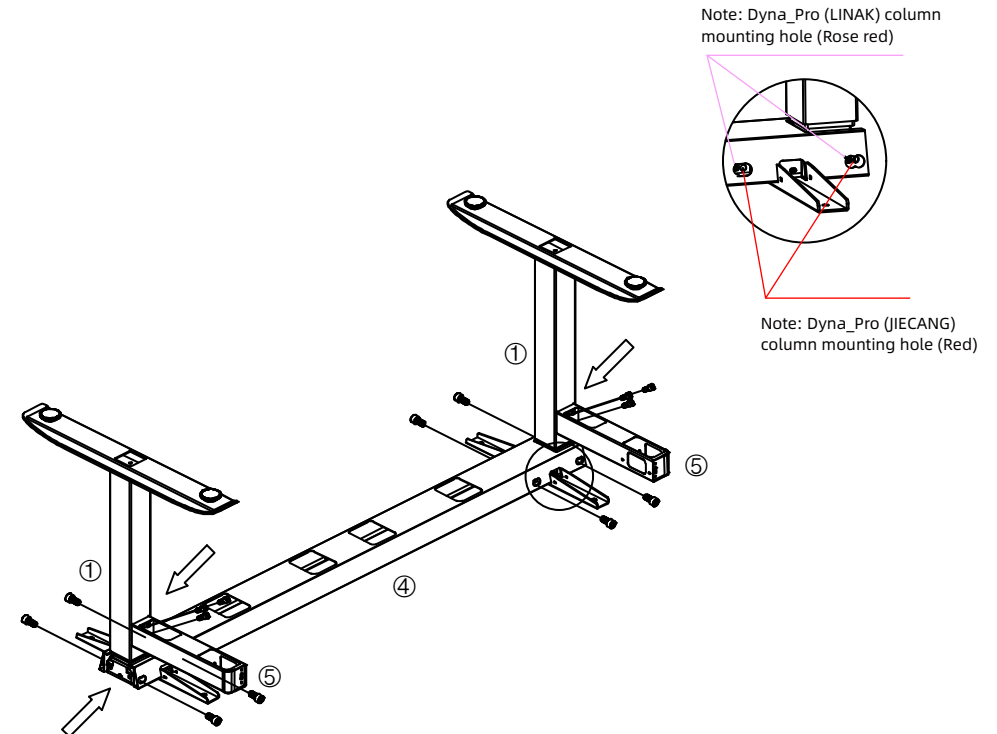

Note: Do not lock the screws on both sides of the lifting column, and the screw length can only be M6-12. Otherwise, it may cause damages to the motor and abnormal noise.

Step 3

1. Install ⑥ the wireway and ⑤ connecting pipe
(Hexagon socket cylindrical head screw M6-12)

Pay attention to the routing direction;

The top edge of wireway must be flush with the connecting pipe;

The mounting surface must be tightly fitted

2. Install the cables of lifting table

The controller (rose red) is arranged between two holes with the plane downward; it is located in the direction of routing;

convenient for connection with the table board

Gyroscope (Cyan) is mounted on the side of the controller

Motor wire (yellow) column (green) power cable (red)

hand controller (blue) installed on the right

3. Install ⑦ the rubber gasket of table board

4. Install ⑧ the heightened pad

(Cross recessed big flat head tapping screw ST3.5*12)

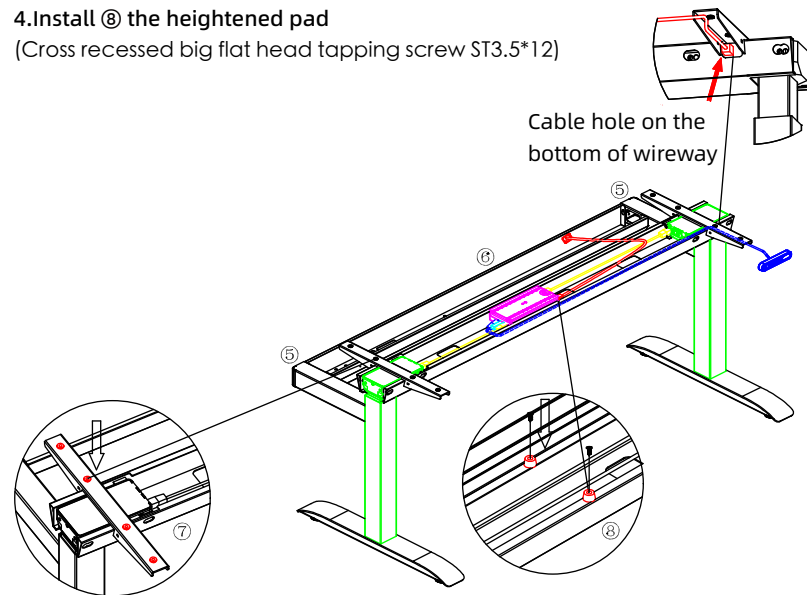

Step 4

1. Install ⑩ the screen

First align the screen hole with the waist-type hole of the connecting pipe, and then mount the screws from the inside ⑤

(Hexagon socket cylindrical head screw M6-12)

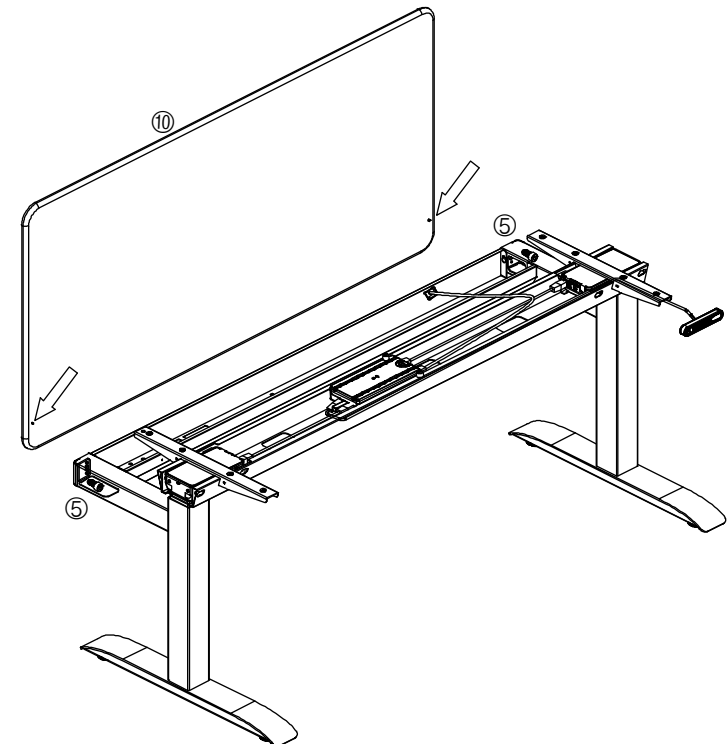

Note: Make sure the table frame is placed horizontally before locking the bolts on both sides of the lifting column, so as to avoid uneven table top after installation;

Step 5

1. Install the middle wireway
(Hexagon socket cylindrical head screw M6-12)
2. Install the top wireway
(Hexagon socket cylindrical head screw M6-12)
3. Install another section of workstation
(Hexagon socket cylindrical head screw M6-12)

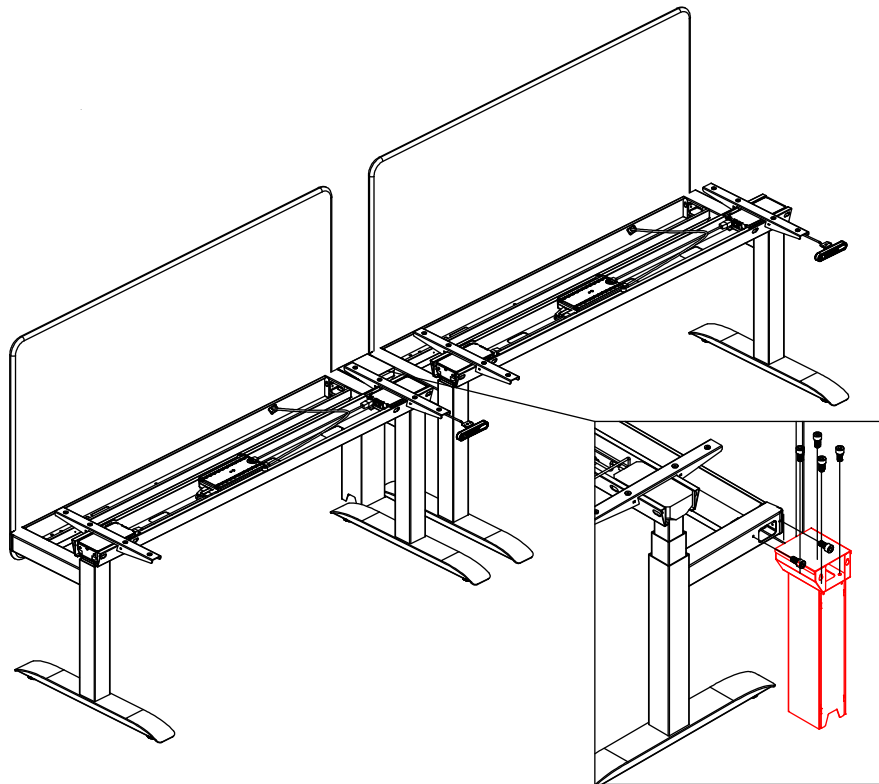

Step 6

1. Install the middle wireway
(Hexagon socket cylindrical head screw M6-16)
2. Install the top wireway
(Hexagon socket cylindrical head screw M6-16)
3. Install another section of workstation
(Hexagon socket cylindrical head screw M6-16)

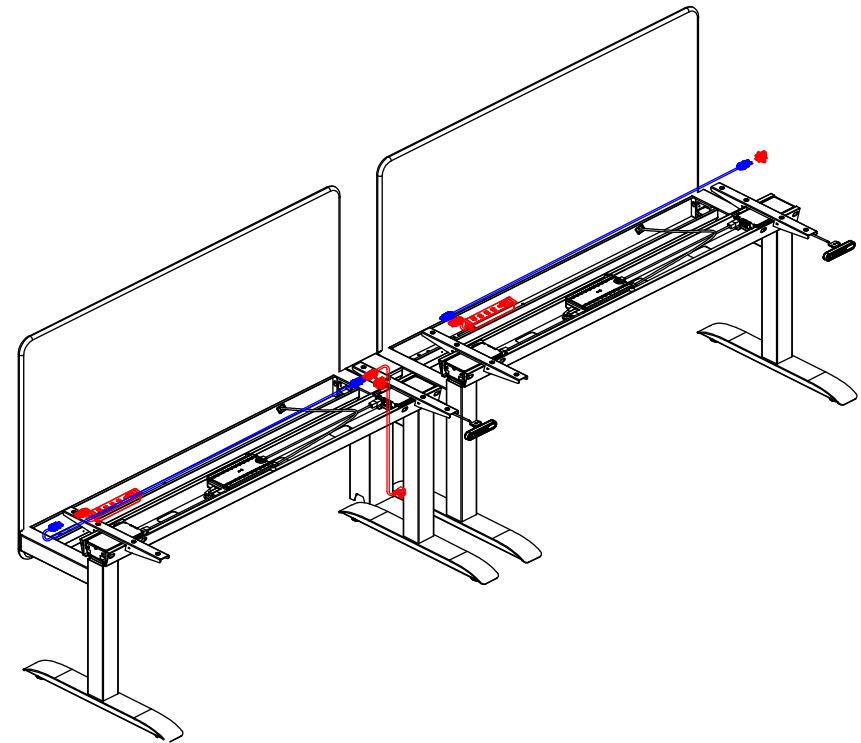

Step 7

1. Install the wireway cover
2. Install the end cover of wireway
3. Install the pallet of wireway
(Hexagon socket cylindrical head screw M6-16)
4. Test if the lifting system runs normally and check if the circuits are plugged in firmly
5. Install the cover of undertable wireway (ABS)(Fig.1)

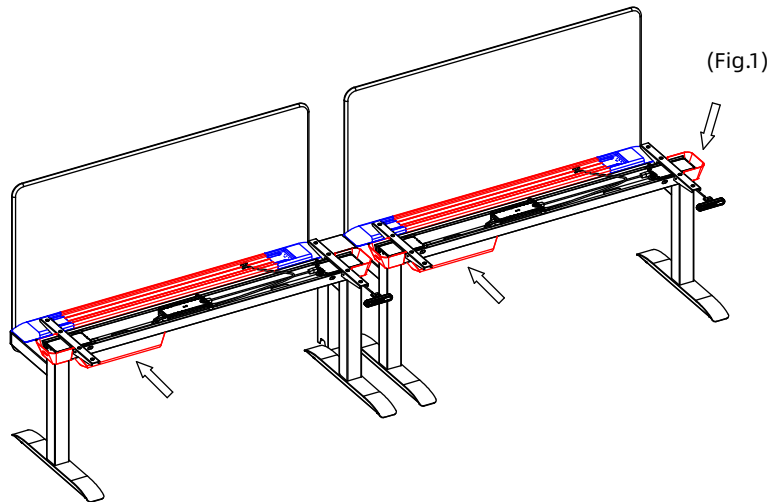

Step 8

1. Install the table board
(Cross recessed pan head tapping screw ST5.5*20)
The table board must be aligned with two ends of the table stand
Table board clearance 25mm in the direction of width;
12.5mm of clearance between the table board and creen in the direction of depth
2. Install the tank chain to fix table board along the side of end cover of wireway (Fig.1)
3. Plug relevant cables inside the tank chain
(Note: Unlocking direction of cable chain)

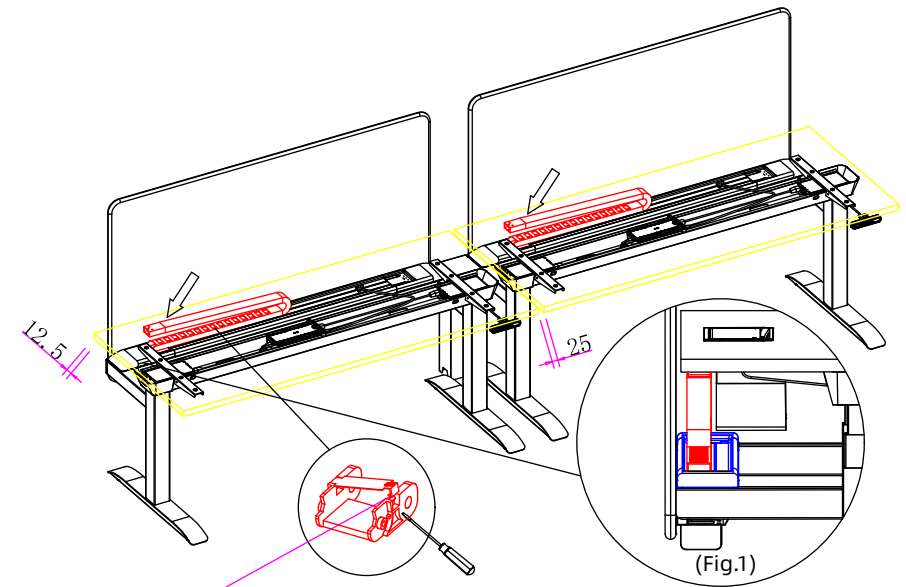

Cable chain wiring installation_Pry open using straight screwdriver

Step 9

1.Install the support arm of undertable wireway (ABS) (Fig.2)

2.Install the hand controller(Model DPF1C. The mounting screws of different hand controllers have different specifications)

with the cable attached to the support arm (Fig.3)

(DPF1C_Cross recessed pan head tapping screw ST3.5*16)

(DPF1K_Cross recessed pan head tapping screw ST3.5*16)

(DPG1C_Cross recessed raised countersunk head tapping screw ST3.5*32)

3.Fix the controller on the table board (Fig.4)

(Cross recessed pan head tapping screw ST4.2*45)

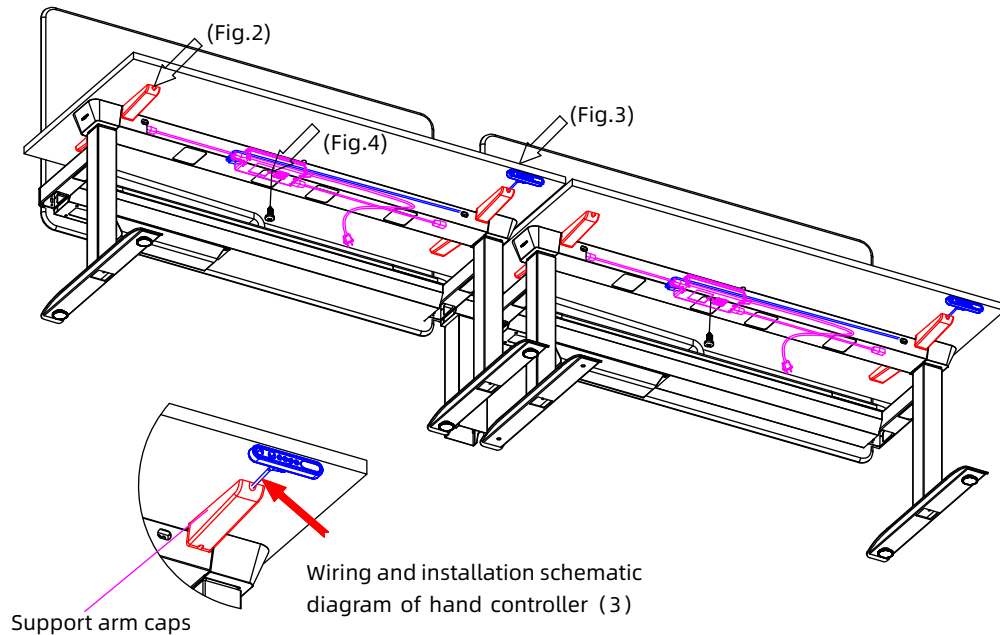

Step 10

1.If ABS opening mode of table board is selected, steel wire box needs to be installed, bypassing the position of tank chain; The side of steel wire box faces towards the opening side of table board (Cross recessed pan head tapping screw ST5.5*20)

