

Gate

Single-sided Leg Manager's Desk

NOVAH[®]

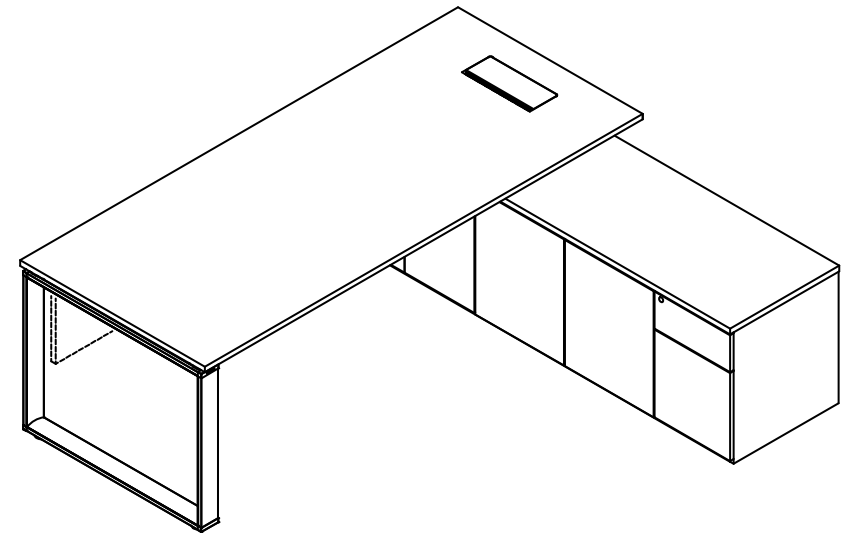

NOVAH System Technology Co.,Ltd.
Tel: 400-115-1688
Web: www.novah.cc
Mail: int@novah.cc

NOVAH[®]

Product Parts List



Three-in-one
eccentric lever L=40



Wooden dowel



Three-in-one
eccentric wheel $\phi 15$



Countersunk
self-tapping screws
(M4*16)



Three-in-one cover B



Shelf support pin



Rubber cover of shelf support pin



Cross recessed countersunk
head tapping screw
(5*20)



Cross recessed countersunk
head tapping screw
(5*70)

Step 1



Hexagon socket cylindrical head screw
(M6*16)



Hexagon socket cylindrical head screw
(M6*30)



Hexagon socket cylindrical head screw
(M8*30)



Hexagon socket cylindrical head screw
(Including assorted spring washer)
(M8*45)

1. Base plate: Insert wooden dowel into wooden dowel hole; screw the eccentric lever into the pre-buried hole with screwdriver and other tools;

2. Install roof panel, back panel and external side panel into corresponding holes;

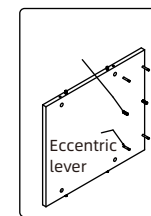

Openable door's external side panel

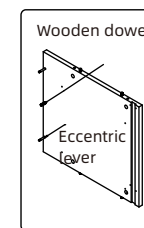

Drawer's external side panel

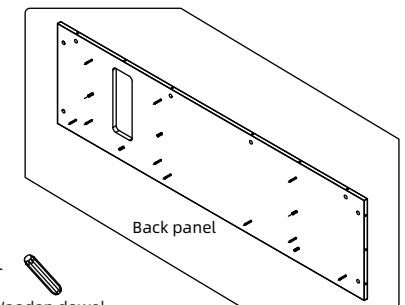

Back panel

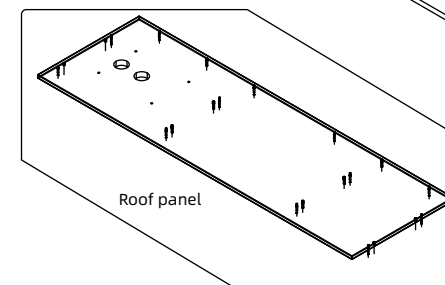

Roof panel

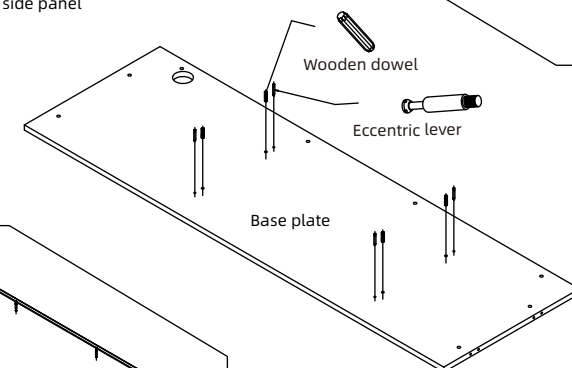

Base plate

Step 2

1. Install side cabinet's upper wiring terminal

Step 1: Install the short upper wiring terminal onto the back panel through wooden dowel and eccentric lever, screw down and fix with eccentric wheel (see Fig. 1);

Step 2: Install the tall upper wiring terminal onto the upper wiring terminal through wooden dowel and eccentric lever, screw down and fix with eccentric wheel (see Fig. 2)

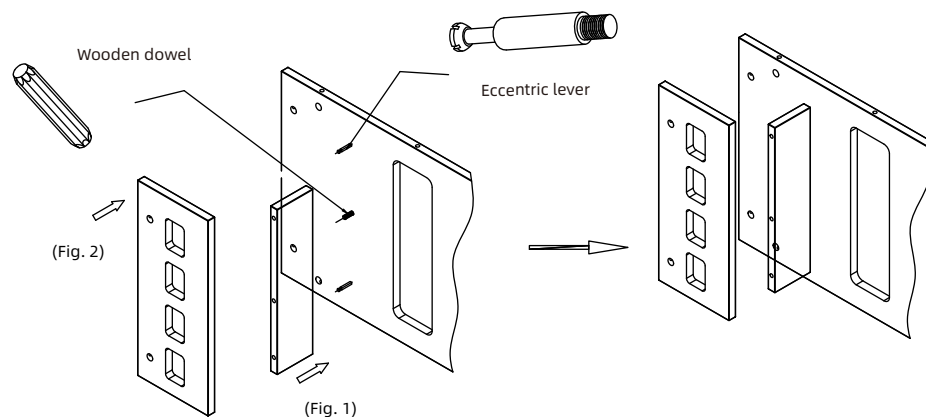

Step 3

1. Install side cabinet's roof panel guide rail and sliding door

Step 1: Install the external side panel onto the tall wiring terminal and the back panel through wooden dowel and eccentric lever, screw down and fix with eccentric wheel (see Fig. 1);

Step 2: Install the external side panel onto the back panel through wooden dowel and eccentric lever, screw down and fix with eccentric wheel (see Fig. 2);

Step 3: Install the middle riser onto the back panel through wooden dowel and eccentric lever, screw down and fix with eccentric wheel (see Fig. 3)

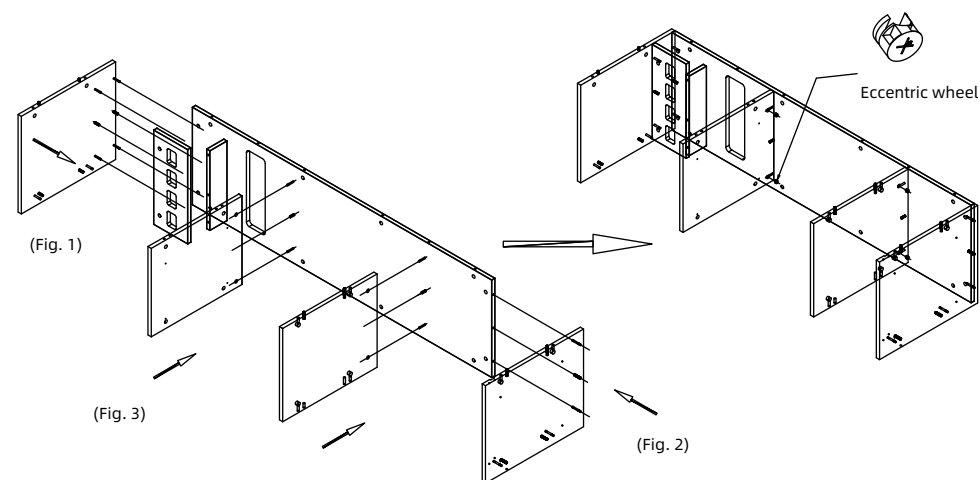

Step 4

1. Install side cabinet's roof panel and base plate

Step 1: Install the roof panel onto the external side panel, the middle riser and the back panel through wooden dowel and eccentric lever, screw down and fix with eccentric wheel (see Fig. 1);

Step 2: Install the base plate onto the external side panel, the middle riser and the back panel through wooden dowel and eccentric lever, screw down and fix with eccentric wheel (see Fig. 2)

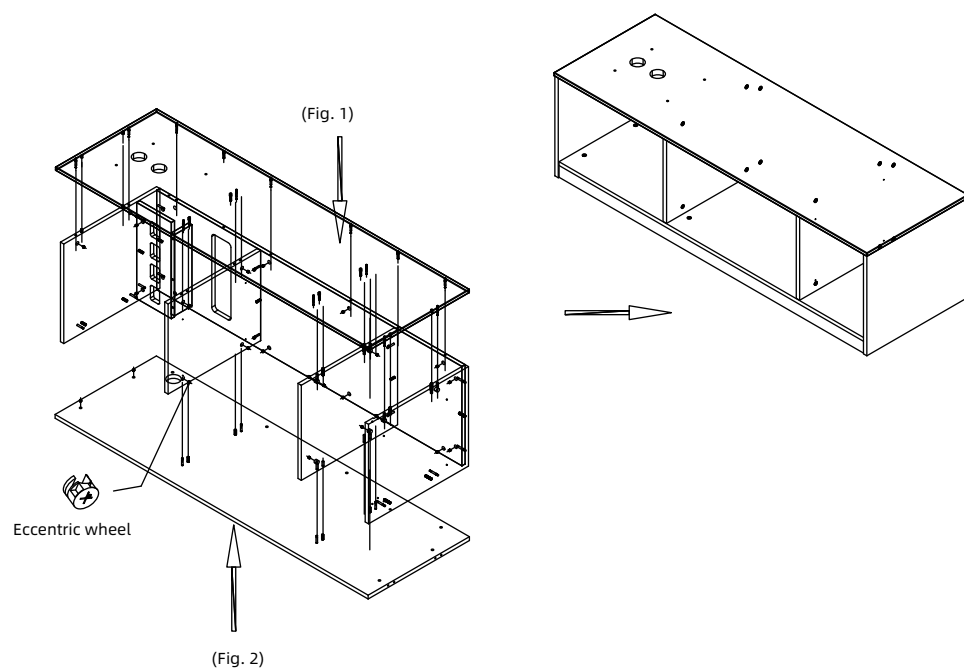

Step 5

1. Install side cabinet's single door, adjust door gap;

Install movable shelf board's shelf support pin and rubber cover;

Install drawer's guide rail on the side panel and the middle riser, and link rod lock's rod (adopting lock rod's fixing sheet and fitting)

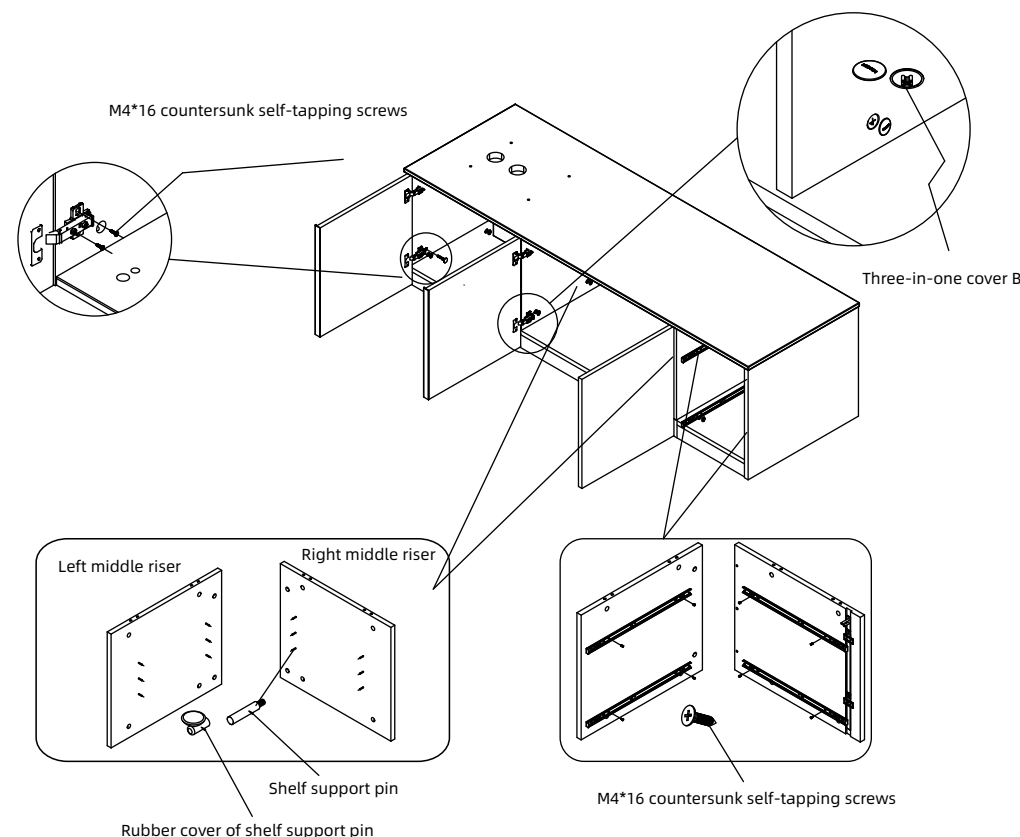

Step 6

1.Install side cabinet's movable shelf board and drawer

I.Drawer panel and drawer are connected and fixed with self-tapping screws;

II.Install lock head;

III.Install the drawer into the cabinet, adjust the drawer's pull-push smoothness;

IV.Adjust locker rod to appropriate height and guarantee that drawer could be closed and locked tightly

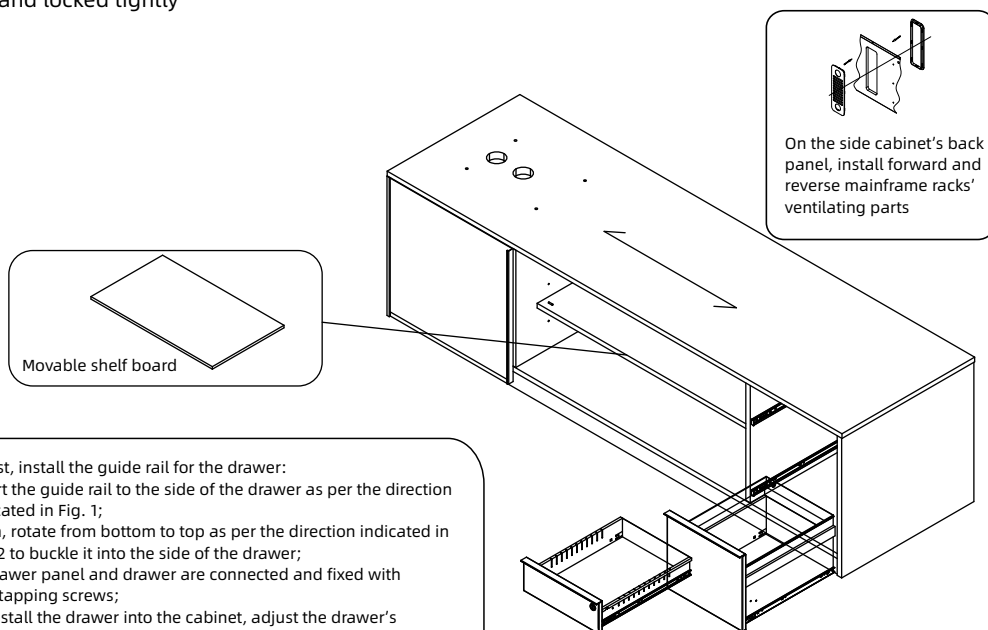

I. First, install the guide rail for the drawer:
Insert the guide rail to the side of the drawer as per the direction indicated in Fig. 1;
Then, rotate from bottom to top as per the direction indicated in Fig. 2 to buckle it into the side of the drawer;
II. Drawer panel and drawer are connected and fixed with self-tapping screws;
III. Install the drawer into the cabinet, adjust the drawer's pull-push smoothness;
IV. Adjust locker rod to appropriate height and guarantee that drawer could be closed and locked tightly;
V. Install lock head to the small drawer panel.

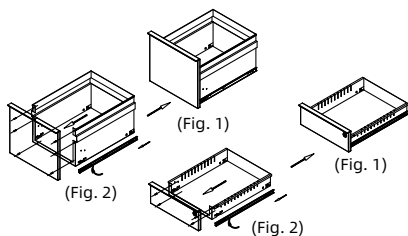

Step 7

1.Install side cabinet's support cabinet

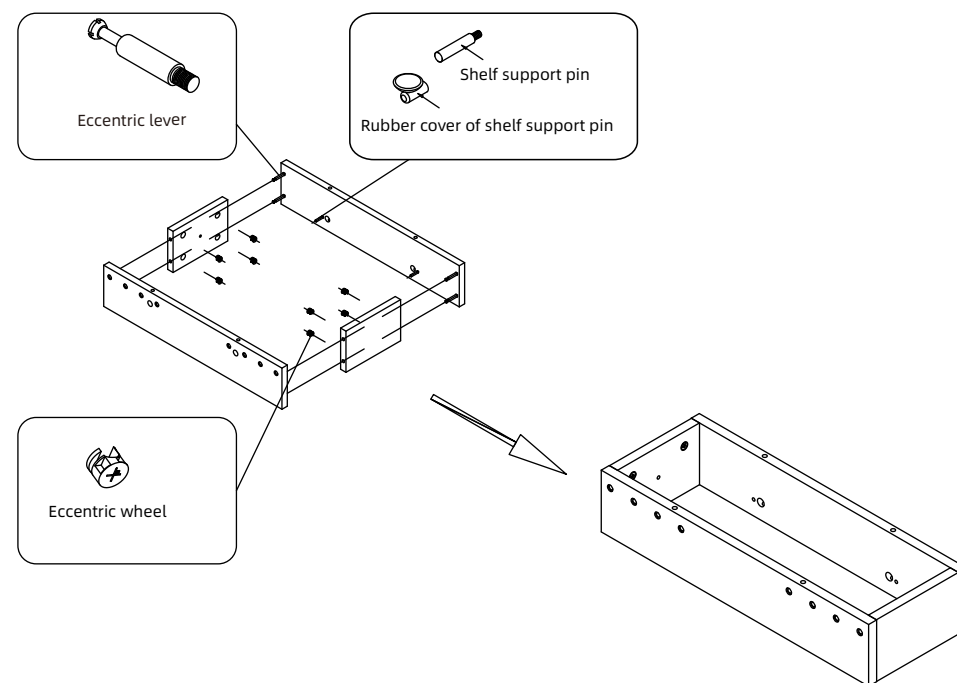

Step 8

1.Side cabinet is installed completely

Note: After support cabinet is fixed to side cabinet's roof panel with eccentric wheel, buckle up cover B; fix the shelf support pin below, and put it in the shelf; fix it to the shelf surface with 2 shelf support pins, in order to prevent the shelf board from being taken out during power supply plug and unplug!

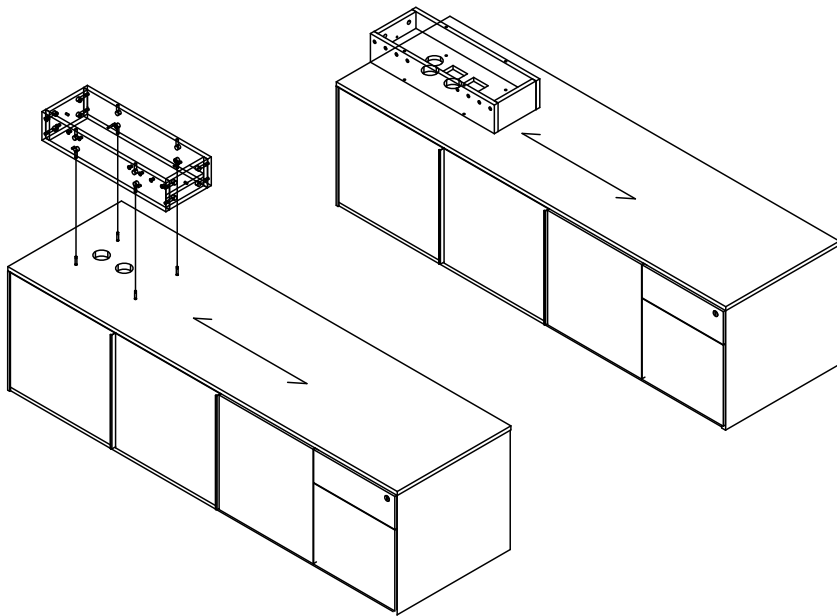

Installation instructions for Gate single-sided leg Manager's desk side cabinet (length W1800mm):

1. All the above installation steps are based on the side cabinet (length W1800mm)!
- 2.This side cabinet's installation instructions are suitable for all Gate single-sided leg Manager's desk side cabinets!

Step 9

1.Install the side leg and beam

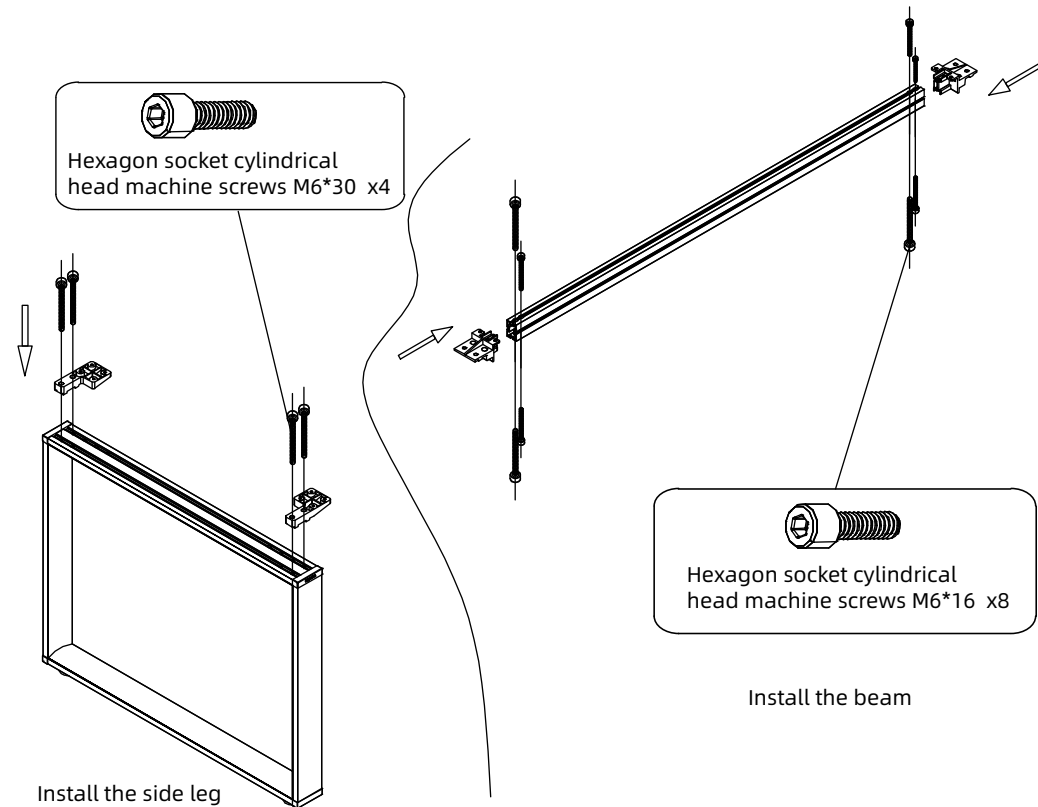

Step 10

1.Install the table leg stand

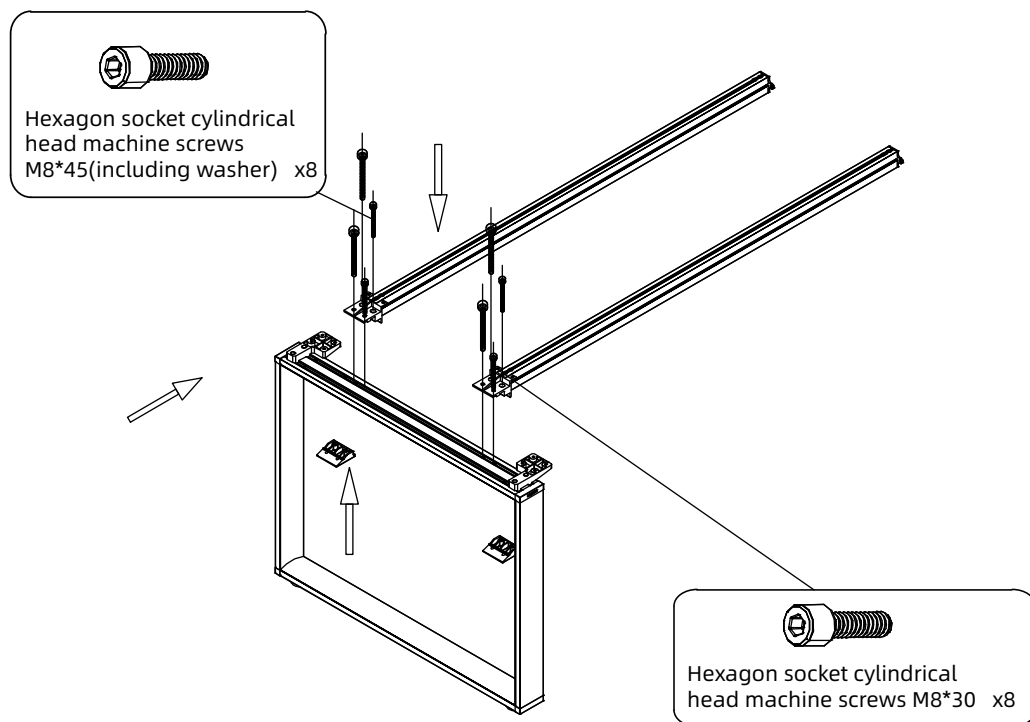

Step 11

1.Install the table stand's beam and side cabinet

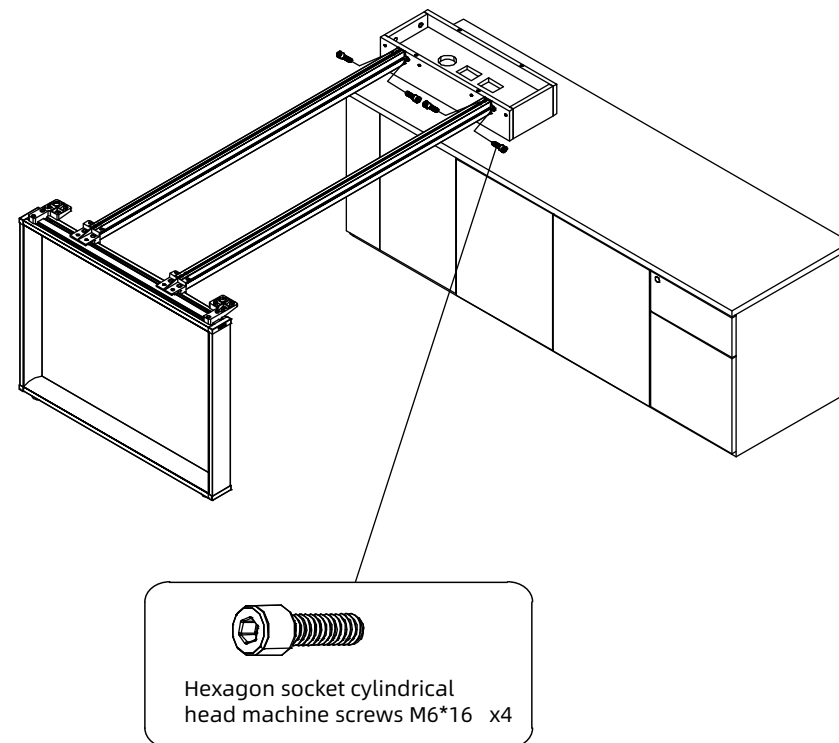

Step 12

1.Install the front baffle

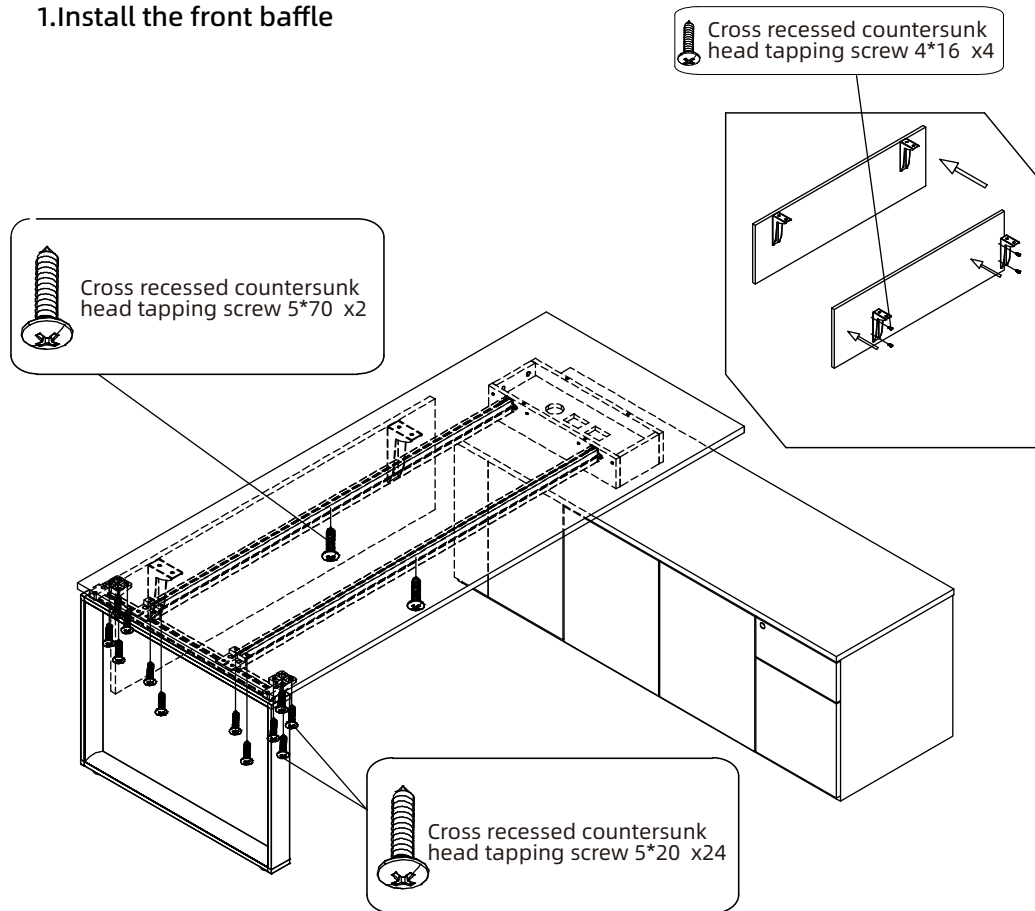

Step 13

1.The installation is complete

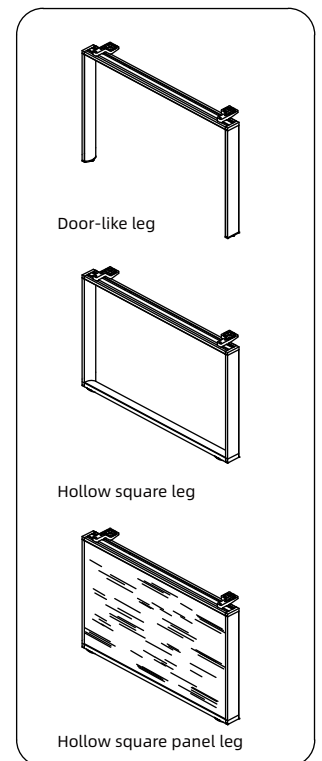
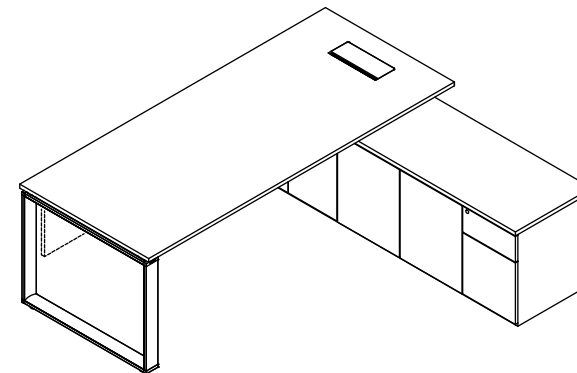

The Door-like leg, hollow square leg and hollow square panel leg are installed in the same way!

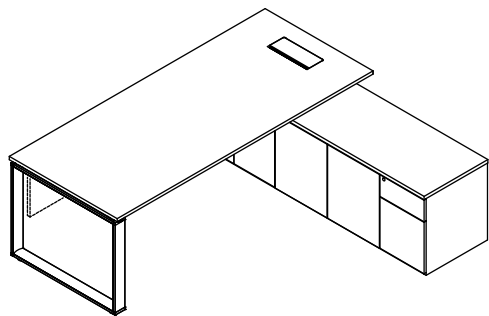

Rectangular manager's desk
with single side leg

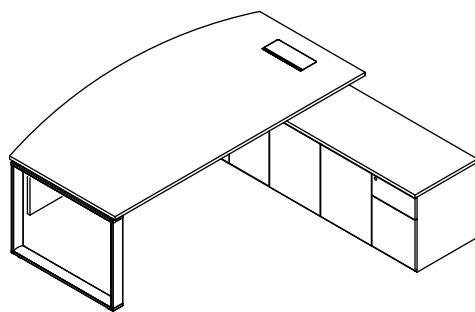

Convex manager's desk
with single side leg